



**Concrete Shear Wall**  
Construction Technology



**Luxury Living**

In the Lap of nature

Happiness  
Just Ahead...





# Bringing Joy to Life

Spring Developers was born out of determination to break fresh ground in the City of Nawabs whose architecture has been admired since ancient times.

Our aim is to set new standards, establish benchmarks in the field of construction and make our clients feel proud on their decision.

Spring Greens is the promising debut that will see Spring Developers revolutionize the way families live and enjoy life.

Spring Greens is a Residential Paradise, where you will explore the beauty of nature and find peace of mind with 75% green and open spaces.









You had promised yourself that you would provide your loved ones with a lifestyle they had always dreamed about. To give them all the comforts and pleasures that life has to offer. To see that glint of happiness and pride in their eyes which wordlessly says **"You are the best"**. Well, the time has come to redeem your promise. The time has come to move to Spring Greens.....

### Parks

- Landscaped parks and pavements
- Jogging track with music
- Lilliput mini amusement park

### Utilities

- Sewage Treatment plant
- Grocery/ Pharmacy Shops
- Rain Water Harvesting

### Stand by Power

- 24X7 Provision for power backup

### Security

- Round the clock manned security at every corner

Project approved for housing loans from SBI, ICICI & DHFL.









Badminton Court

Table Tennis

Lawn tennis Court

Billiards table

Restaurant

Swimming Pool

Gymnasium

Party / Meeting Hall

Club & Amenities



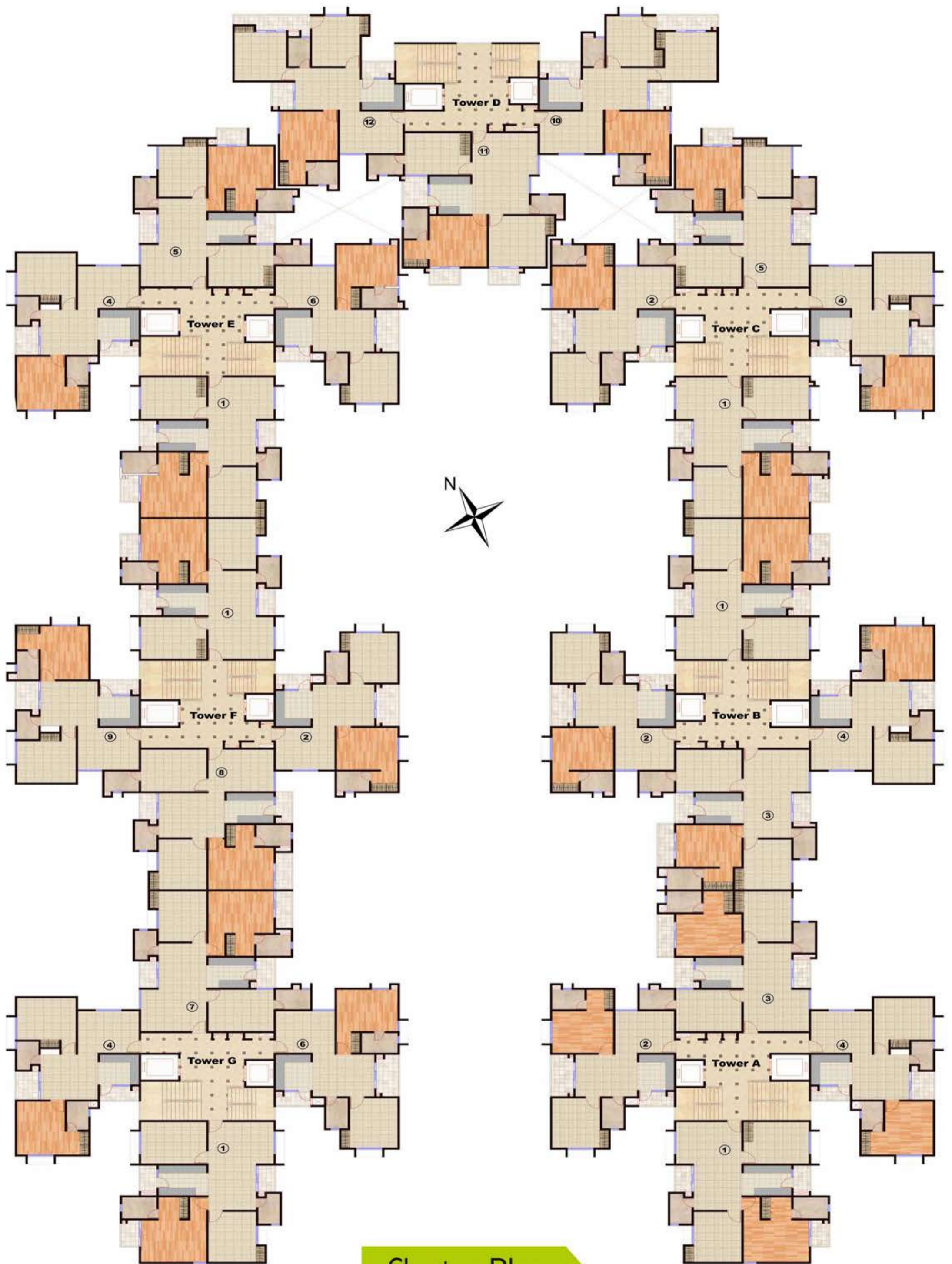

Cluster Plan



# Layout Plan

\*"This is only artistic impression of the master plan. The actual layout, design, specifications, dimensions etc. may be at variance from the indications made subject to site conditions, architectural requirements, aesthetics and statutory approvals."



1 | 3BHK Unit  
1450 Sq. Ft.



2 | 2BHK Unit  
1186 Sq. Ft.



3 | 3BHK Unit  
1502 Sq. Ft.



4 | 2BHK Unit  
1177 Sq. Ft.





5 | 3BHK Unit  
1502 Sq. Ft.



6 | 2BHK Unit  
1186 Sq. Ft.



7 | 3BHK Unit  
1502 Sq. Ft.



8 | 3BHK Unit  
1502 Sq. Ft.





9 | 2BHK Unit  
1177 Sq. Ft.



10 | 3BHK Unit  
1531 Sq. Ft.





11 | 3BHK Unit  
1569 Sq. Ft.



12 | 3BHK Unit  
1517 Sq. Ft.



It's Just about Discovering the quality....

## STRUCTURE



- Earthquake resistant
- Concrete Shear Wall (R.C.C. Wall) Construction Technology

## FLOOR FINISHES



- Living /Dining: Vitrified tiles
- Bedrooms: Laminated Wooden Flooring / Vitrified tiles
- Lobby/Corridors, Staircase: Granite/ Marble Flooring
- Balcony/Toilet/Kitchen: Antiskid Tiles

## WASH ROOM



- Walls: Ceramic tiles up to door height
- Sanitaryware: Branded European W.C., Wash basin, CP fittings
- Fixtures: Provision for Hot and Cold water supply

## KITCHEN



- Granite counter with ceramic tile cladding
- Stainless Steel Sink
- Branded Fixtures with provision for Hot and Cold water supply.
- Provision for Gas Pipeline

## WINDOWS



- UPVC/Anodized Aluminium Windows with Float Glass/ Moulded Steel Designer frame

## DOORS



- Machine made Moulded door shutter with S.S. fittings
- Entrance Door- Teak Veneered and Polished Shutter/ Moulded skin door

## PAINTING



- Internal Walls finished with putty (cement based) & painted with plastic emulsion.
- External walls with pleasing elevation & Semi-Permanent finish / All weather exterior paints.

## ELECTRICAL AND COMMUNICATION



- Concealed copper wiring with adequate modular switch points.
- Provision for telephone points in drawing, dining and all bedrooms.
- Provision of DTH points in drawing, dining and all bedrooms.



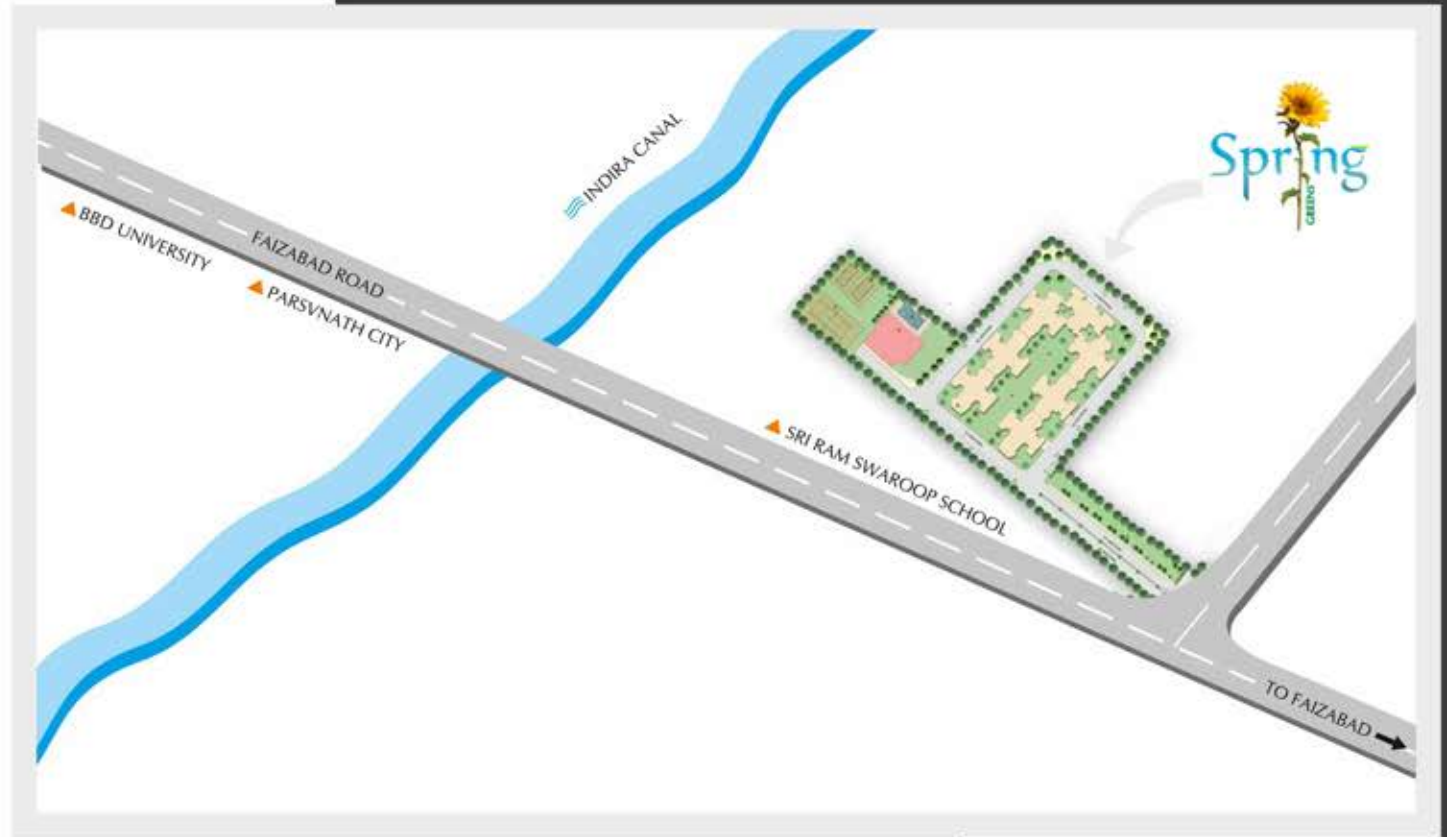

Designed By : Redcube Advertisements, +91 9616374259



Office Add :

B-46, Vibhuti Khand, Gomti Nagar, Lucknow

Site Add :

334, Anaura, Adjoining Ramswaroop School, Faizabad Road, Lucknow

Phone : 0522- 2994040, 2994050, +91 9235606062, +91 9235606080, Email : [springdevelopers@gmail.com](mailto:springdevelopers@gmail.com), [springdevelopers@yahoo.in](mailto:springdevelopers@yahoo.in)